

Request for Proposal (RFP)

Issued by:

WEST CENTRAL TEXAS COUNCIL OF GOVERNMENTS



For:

Construction of Commercial driveway
For the West Central Texas Council of
Governments

Proposals to be Submitted to:

WCTCOG Homeland Security Department
3702 Loop 322
Abilene, Texas 79602

Issue Date:

Thursday, August 28th, 2025

Proposal Due Date and Time:

Tuesday, September 30th, 2025, at 4:00pm
(Late bids will not be accepted)

Introduction

A. Background

The WCTCOG is a political subdivision or governmental unit of the state of Texas serving the 19-counties, including cities and other districts, of Brown, Callahan, Coleman, Comanche, Eastland, Fisher, Haskell, Jones, Kent, Knox, Mitchell, Nolan, Runnels, Scurry, Shackelford, Stephens, Stonewall, Taylor, and Throckmorton in a rural area encompassing 18,000 square miles.

B. General Information

The West Central Texas Council of Governments (WCTCOG) is requesting proposals from qualified contractors for the construction of two-way commercial driveway for the West Central Texas Council of Governments located in Abilene, TX. All proposals must be submitted not later than September 30th, 2025, at 4:00pm. There is no expressed or implied obligation for WCTCOG to reimburse the responding contractors for any expenses incurred in preparing proposals in response to this request. To be considered, a proposal must be received via email to kcollom@westcentraltexas.org by 4:00 P.M., September 30th, 2025.

WCTCOG reserves the right to reject any or all proposals submitted. Proposals submitted will be evaluated by the Executive Committee assisted by WCTCOG staff.

During the evaluation process, the Executive Committee of WCTCOG reserves the right, where it may serve the Council's best interest, to request additional information or clarifications from proposers, or to allow corrections of errors or omissions. At the discretion of the Executive Committee, firms submitting proposals may be requested to make oral presentations as part of the evaluation process.

The WCTCOG reserves the right to retain all proposals submitted and to use any ideas in a proposal regardless of whether that proposal is selected. Submission of a proposal indicates acceptance by the firm of the conditions contained in this request for proposals, unless clearly and specifically noted in the proposal submitted and confirmed in the contract between the WCTCOG and the contractor selected.

C. Terms of Engagement

Construction of two-way driveway in compliance with TxDot standards.

Nature of Services Required

Scope of work to be Performed.

Construction of two-way driveway & temporary bypass for the West Central Texas Council of Governments located in Abilene, TX. Project is located at: 3702 Loop 322, Abilene, TX 79602

Please include the following in Proposal

1. Materials & Labor

Proposal will include breakdown of materials used and labor needed to complete the project. All materials and labor must comply with TxDOT standards, and the schematics provided. If there are issues pertaining to the specifications, please contact Keith Collom with the WCTCOG Homeland Security Department at kcollom@westcentraltexas.org.

Project Specifications

- Two-way commercial driveway
- One entry lane & one exit lane
- 6" min reinforced concrete
- Two culverts (round or oval)
- No Curbing or guttering
- Temporary Entrance

See attached schematics

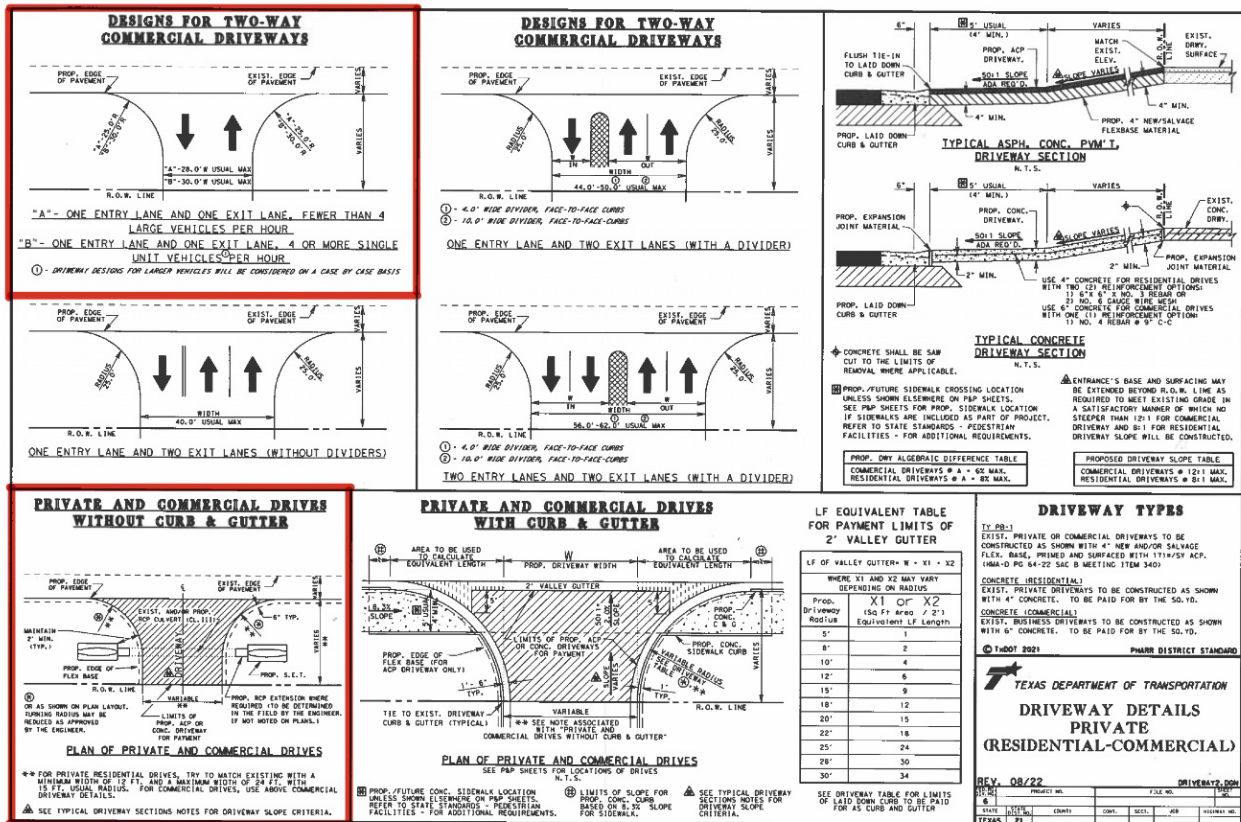

2. Installation

Please include the estimated time needed and cost (materials & labor) for the construction of the driveway and any additional components in the price summary. Installation will follow the guidelines and specifications outlined by TxDot (Texas Department of Transportation).

3. Price Summary

A required price summary for each proposal should provide a clear and legible understanding of the materials and labor needed to construct the driveway.

4. Temporary Entrance

Include all associated costs in pricing summary for the construction of temporary bypass entrance, north of entrance project. Bypass will need to be maintained during the duration of the proposed project.

Description of Entity

1. Name and Telephone Number of Contact Person

The contractor's principal contact with the WCTCOG will be Keith Collom, Emergency Management Program Coordinator, 3702 Loop 322, Abilene, Texas, via e-mail kcollom@westcentraltexas.org or telephone 325-672-8544.

2. References

Contractor is to provide **three (3)** references for management or construction of similar projects completed. Send reference information via email to kcollom@westcentraltexas.org.

Proposal Requirements

1. Quote for project, please include:
 - a. Clear descriptions of materials
 - b. Estimated price for completion of project.
2. Proof of Licensing (if applicable)
3. Permits from the City of Abilene and/or TxDOT may be required and are at the expense and the responsibility of the vendor receiving the award.
4. Three (3) applicable references

Evaluation Procedures

1. Proposal Review

Responsive proposals submitted by the deadline will be evaluated and scored according to the following criteria and presented to the WCTCOG Executive Committee for review and selection.

COST WILL NOT BE THE PRIMARY FACTOR IN THE SELECTION OF A PROJECT VENDOR.

<u>Evaluation Factors</u>	<u>Possible Points</u>
Best Value to the Project and the WCTCOG	40
Professional Experience & References	40
Compliance with RFP Specifications	20
Total	100

2. Right to Reject Proposals

Submission of a proposal indicates acceptance by the contractor of the conditions contained in this request for proposals unless clearly and specifically noted in the proposal submitted and confirmed in the contract between the WCTCOG and the firm selected.

THE WEST CENTRAL TEXAS COUNCIL OF GOVERNMENTS RESERVES THE RIGHT WITHOUT PREJUDICE TO REJECT ANY OR ALL PROPOSALS.

3. Final Selection

Anticipated decision within 60 days of bid closing.

Temporary Entrance Location and Pictures



DESIGNS FOR TWO-WAY COMMERCIAL DRIVEWAYS

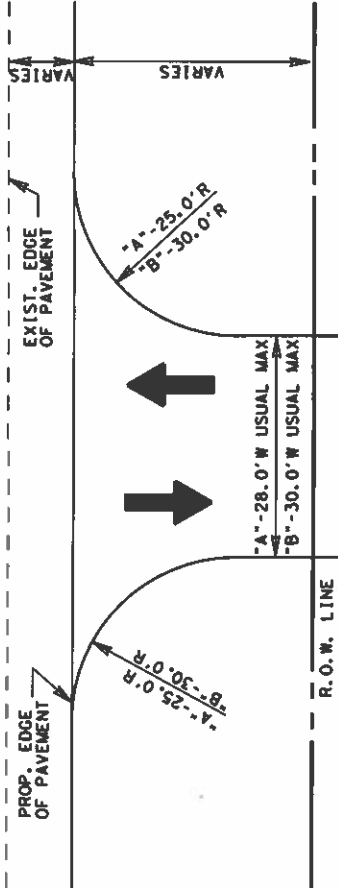

"A" - ONE ENTRY LANE AND ONE EXIT LANE, FEWER THAN 4 LARGE VEHICLES PER HOUR
"B" - ONE ENTRY LANE AND ONE EXIT LANE, 4 OR MORE SINGLE UNIT VEHICLES PER HOUR

① - DRIVEWAY DESIGNS FOR LARGER VEHICLES WILL BE CONSIDERED ON A CASE BY CASE BASIS

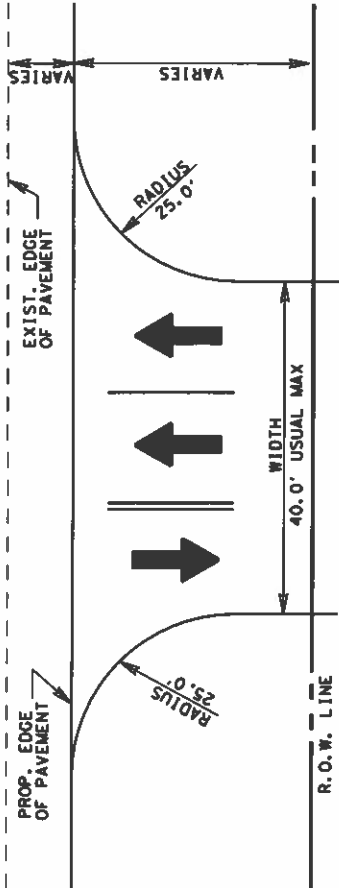

ONE ENTRY LANE AND TWO EXIT LANES (WITHOUT DIVIDERS)

DESIGNS FOR TWO-WAY COMMERCIAL DRIVEWAYS

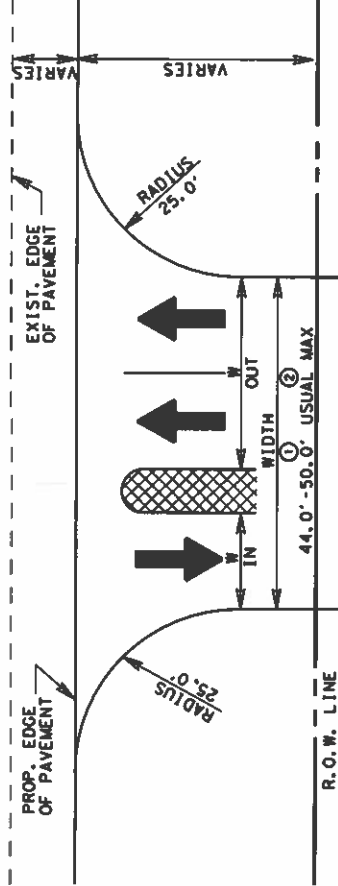

① - 4.0' WIDE DIVIDER, FACE-TO-FACE CURBS
② - 10.0' WIDE DIVIDER, FACE-TO-FACE CURBS

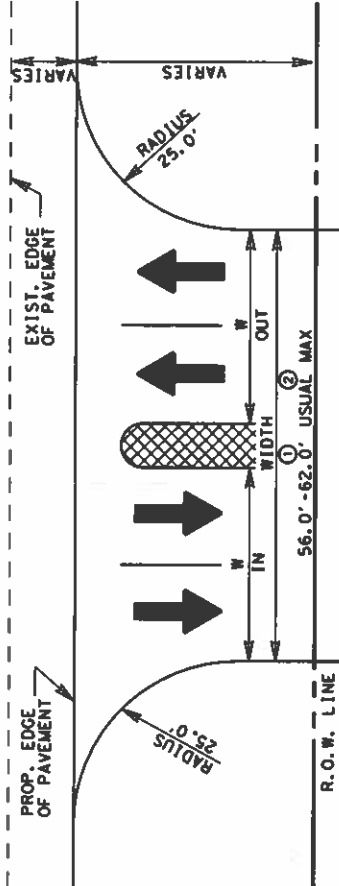

① - 4.0' WIDE DIVIDER, FACE-TO-FACE CURBS
② - 10.0' WIDE DIVIDER, FACE-TO-FACE CURBS

PRIVATE AND COMMERCIAL DRIVES WITHOUT CURB & GUTTER

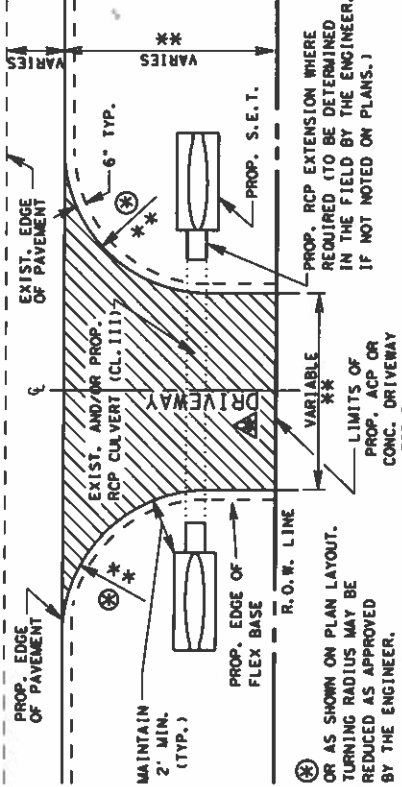

PLAN OF PRIVATE AND COMMERCIAL DRIVES

** FOR PRIVATE RESIDENTIAL DRIVES, TRY TO MATCH EXISTING WITH A MINIMUM WIDTH OF 12 FT. AND A MAXIMUM WIDTH OF 24 FT. WITH 15 FT. USUAL RADIUS. FOR COMMERCIAL DRIVES, USE ABOVE COMMERCIAL DRIVEWAY DETAILS.

SEE TYPICAL DRIVEWAY SECTIONS NOTES FOR DRIVEWAY SLOPE CRITERIA.

PRIVATE AND COMMERCIAL DRIVES WITH CURB & GUTTER

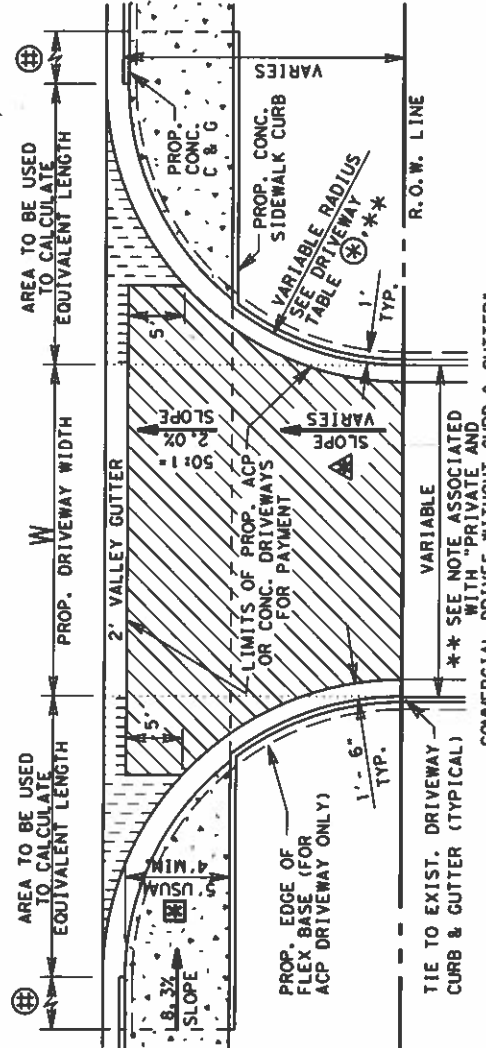

PLAN OF PRIVATE AND COMMERCIAL DRIVES

SEE P&P SHEETS FOR LOCATIONS OF DRIVES

PROPOSED FUTURE CONC. SIDEWALK LOCATION UNLESS SHOWN ELSEWHERE ON P&P SHEETS. REFER TO STATE STANDARDS - PEDESTRIAN FACILITIES - FOR ADDITIONAL REQUIREMENTS.

LIMITS OF SLOPE FOR PROP. CONC. CURB DRIVEWAY SLOPE CRITERIA.

LF EQUIVALENT TABLE FOR PAYMENT LIMITS OF 2' VALLEY GUTTER

Prop. Driveway Radius	Equivalent LF Length
5'	1
8'	2
10'	4
12'	6
15'	9
18'	12
20'	15
22'	18
25'	24
28'	30
30'	34

SEE DRIVEWAY TABLE FOR LIMITS OF LAID DOWN CURB TO BE PAID FOR AS CURB AND GUTTER

TYPICAL ASPH. CONC. PVM'T. DRIVEWAY SECTION

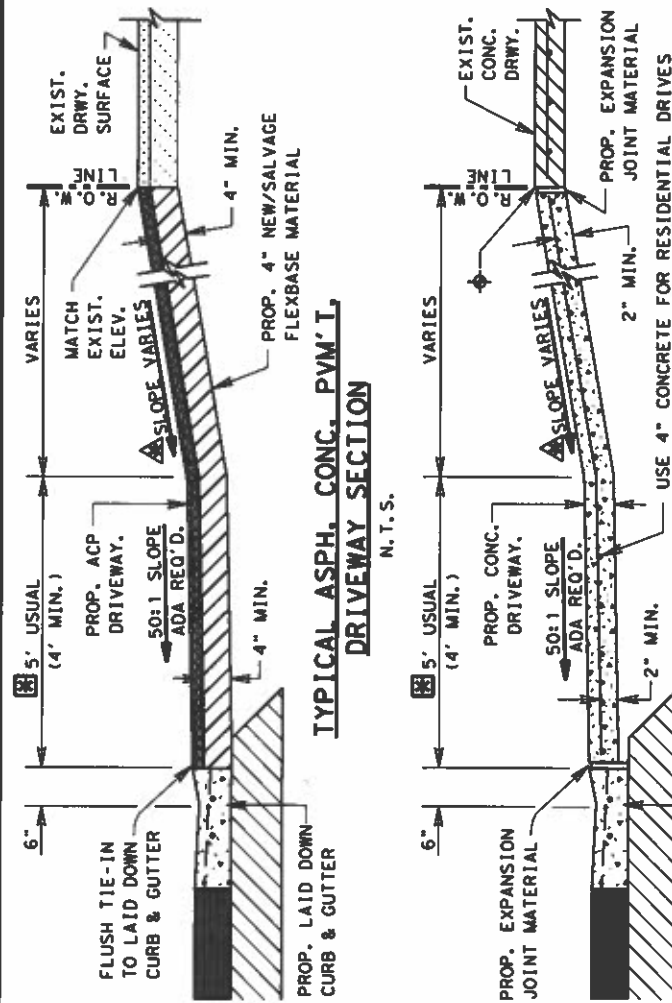

TYPICAL CONCRETE DRIVEWAY SECTION



PROPOSED DRIVEWAY SLOPE TABLE
COMMERCIAL DRIVEWAYS @ 12:1 MAX.
RESIDENTIAL DRIVEWAYS @ 8:1 MAX.

PROPOSED DRIVEWAY SLOPE TABLE
COMMERCIAL DRIVEWAYS @ 12:1 MAX.
RESIDENTIAL DRIVEWAYS @ 8:1 MAX.

DRIVEWAY TYPES

TY PB-1
EXIST. PRIVATE OR COMMERCIAL DRIVEWAYS TO BE CONSTRUCTED AS SHOWN WITH 4" NEW AND/OR SALVAGE FLEX. BASE, PRIMED AND SURFACED WITH 171W/SY ACP. (HMA-D PG 64-22 SAC B MEETING ITEM 340)

CONCRETE (RESIDENTIAL)
EXIST. PRIVATE DRIVEWAYS TO BE CONSTRUCTED AS SHOWN WITH 4" CONCRETE. TO BE PAID FOR BY THE SQ. YD.

CONCRETE (COMMERCIAL)
EXIST. BUSINESS DRIVEWAYS TO BE CONSTRUCTED AS SHOWN WITH 6" CONCRETE. TO BE PAID FOR BY THE SQ. YD.

PHARR DISTRICT STANDARD

TEXAS DEPARTMENT OF TRANSPORTATION

DRIVEWAY DETAILS
PRIVATE
(RESIDENTIAL-COMMERCIAL)

REV. 08/22

PROJECT NO.	FILE NO.	SHEET NO.
STATE	COUNTY	JOB
DATE	CONTRACT	HIGHWAY NO.
21		